

F2.

Profile to create a shadowline

2023

Our company's shadowline profile is a modern false ceiling design that makes your room look spectacular. With a large variety of solutions you may choose the most suitable for you and high quality materials assure durability and safety.

Content

Aluminium shadowline profile (accessories, drawings, installation examples and coating options)

> F2.520	4
> F2.1020	6
> F2.D1020	7
> F2.1320L12	8
> F2.D1320L12	9
> F2.2030	10
> F2.D2030	11
> F2.2040L16	12
> F2.D2040L16	13
> F3.16L24	14
> F2.4060L24	15
> F2.10 “Swallow tail”	16

Diffuser

> F0.LD13	18
> F0.LD25	18



Design by Igor Sirov Architects

F2.520

Aluminium shadowline profile. It is installed to the joint lines of the wall and the ceiling to provide a hanging ceiling effect of the entire room. Can be used as a shadowline plinth.

Designed for gypsum plasterboard systems, it is easy to mount and complements modern design solutions.

Material — Aluminum
LED strip channel — without

Length — 3000 mm
Height — 46,6 mm
Width — 34,1 mm

Covering:
> no cover
> Anodized cover, Silver, 15 micron
> painted in Black* (RAL 9005 matte)
> any RAL palette color*

*powder paint

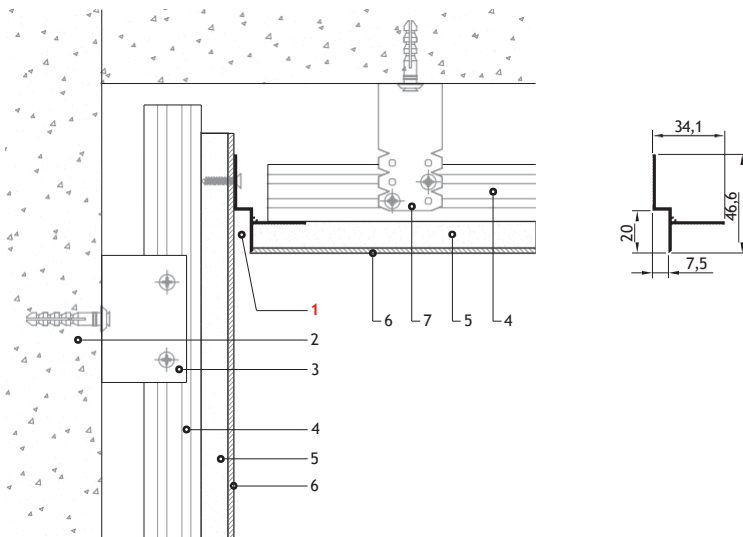

1. Profile F2.520
2. The wall
3. Fastening of the suspension is straight
4. Profile for plasterboard

5. GKL
6. Putty
7. U-shaped suspension



F2.520 — no cover 9 EUR



F2.520A — Anodized cover 12 EUR



F2.520B — painted in Black* (RAL 9005 matte) 12 EUR



F2.520R — any RAL palette color* 14 EUR

F2.1020

Aluminium shadowline profile. It is installed to the joint lines of the wall and the ceiling to provide a hanging ceiling effect of the entire room. Can be used as a shadowline plinth.

Designed for gypsum plasterboard systems, it is easy to mount and complements modern design solutions.

Material — Aluminum
LED strip channel — without

Length — 3000 mm
Height — 46,6 mm
Width — 39,1 mm

Covering:
> no cover
> Anodized cover, Silver, 15 micron
> painted in Black* (RAL 9005 matte)
> any RAL palette color*

*powder paint

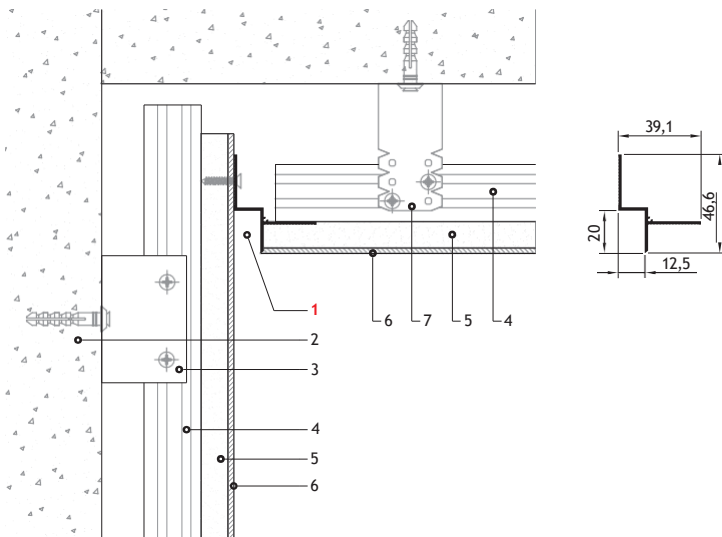

1. Profile F2.1020
2. The wall
3. Fastening of the suspension is straight
4. Profile for plasterboard

5. GKL
6. Putty
7. U-shaped suspension



F2.1020 — no cover

9 EUR



F2.1020A — Anodized cover

12 EUR



F2.1020B — painted in Black* (RAL 9005 matte)

12 EUR



F2.1020R — any RAL palette color*

14 EUR

F2.D1020

Aluminium shadowline profile Separated. It is used to create a shadowline on walls and ceilings to visually separate them.

Designed for gypsum plasterboard systems, it is easy to mount and complements modern design solutions.

Material — Aluminum
LED strip channel — without

Length — 3000 mm
Height — 21,6 mm
Width — 63,2 mm

Covering:
> no cover
> Anodized cover, Silver, 15 micron
> painted in Black* (RAL 9005 matte)
> any RAL palette color*
*powder paint

Accessories:
> End cap F2.D1020P

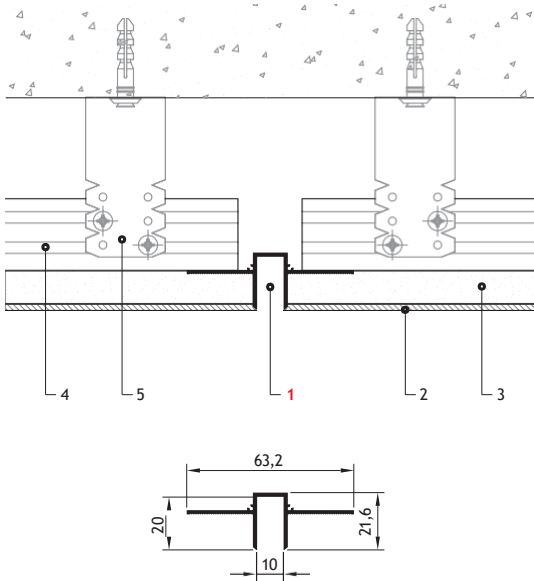

- | | |
|---------------------|-----------------------------|
| 1. Profile F2.D1020 | 4. Profile for plasterboard |
| 2. Putty | 5. U-shaped suspension |
| 3. GKL | |

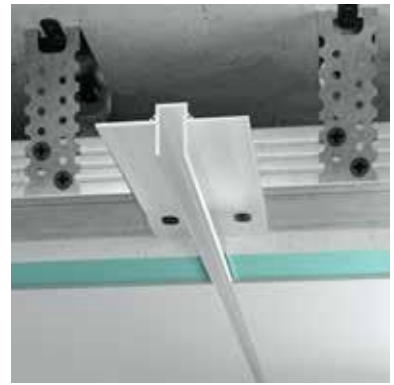

F2.D1020 — no cover 11 EUR

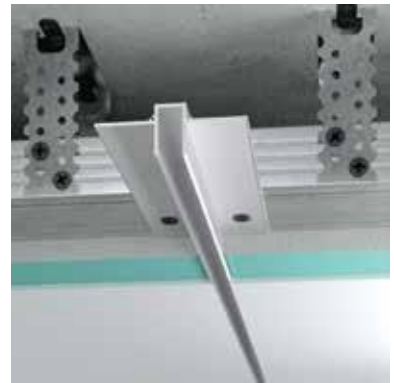

F2.D1020A — Anodized cover 17 EUR

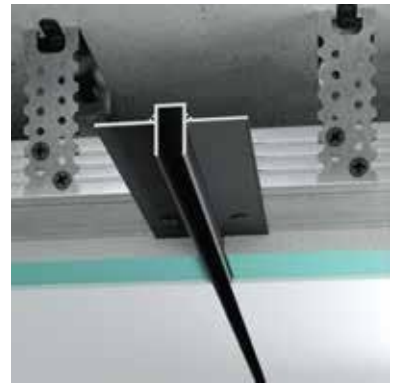

F2.D1020B — painted in Black* (RAL 9005 matte) 17 EUR

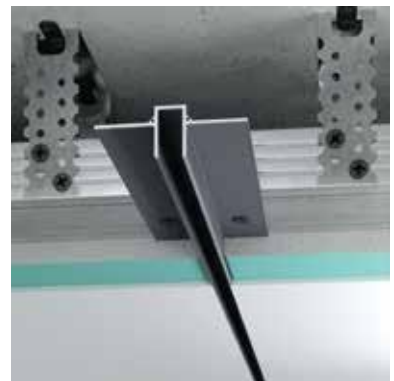





F2.D1020R — any RAL palette color* 18 EUR

F2.1320L12

Aluminium shadowline profile, with a LED strip. It is installed to the joint lines of the wall and the ceiling to provide a hanging ceiling effect of the entire room. With a LED strip channel 12 mm width provides additional room illumination.

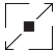
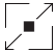
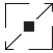
Designed for gypsum plasterboard systems, it is easy to mount and complements modern design solutions.

	Material	—	Aluminum
	LED strip channel	—	to 12 mm
<hr/>			
	Length	—	3000 mm
	Height	—	51,6 mm
	Width	—	41,54 mm
<hr/>			
	Supplemented with:		
	> Diffuser 13 mm F0.LD13		
<hr/>			
	Covering:		
	> no cover		
	> Anodized cover, Silver, 15 micron		
	> painted in Black* (RAL 9005 matte)		
	> any RAL palette color*		
<hr/>			
	*powder paint		

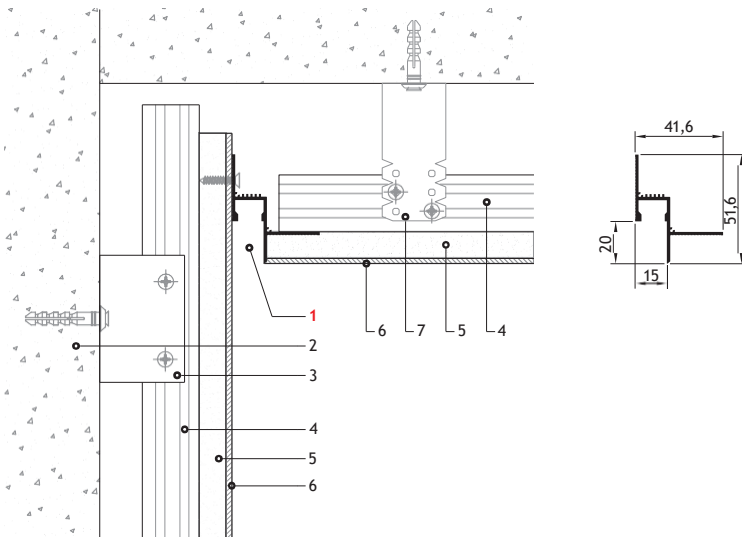

- | | |
|--|------------------------|
| 1. Profile F2.1320L12 | 5. GKL |
| 2. The wall | 6. Putty |
| 3. Fastening of the suspension is straight | 7. U-shaped suspension |
| 4. Profile for plasterboard | |



F2.1320L12 – no cover 10 EUR



F2.1320L12A – Anodized cover 18 EUR



F2.1320L12B – painted in Black* (RAL 9005 matte) 18 EUR



F2.1320L12R – any RAL palette color* 20 EUR

F2.D1320L12

Aluminium shadowline profile Separated, with a LED strip. It is mounted to the joint lines of the wall and the ceiling to provide a hanging ceiling effect of the entire room. With a LED strip channel 12 mm width provides additional room illumination.

Designed for gypsum plasterboard systems, it is easy to mount and complements modern design solutions.

Material	—	Aluminum
LED strip channel	—	to 12 mm

Length	—	3000 mm
Height	—	32,9 mm
Width	—	66,2 mm

Supplemented with:		
> Diffuser 13 mm F0.LD13		

Covering:		
> no cover		
> Anodized cover, Silver, 15 micron		
> painted in Black* (RAL 9005 matte)		
> any RAL palette color*		
*powder paint		



Accessories:
> End cap F2.D1320L12P

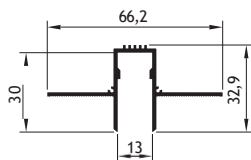
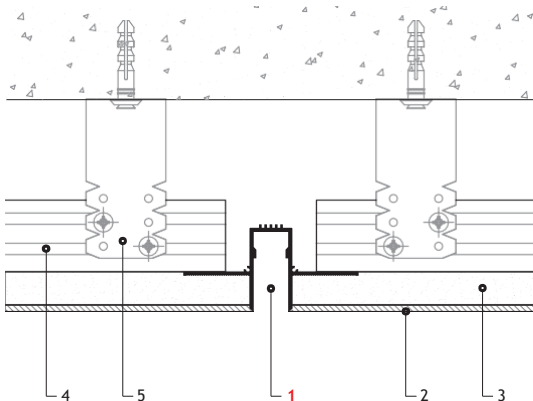

- 1. Profile F2.D1320L12
- 2. Putty
- 3. GKL
- 4. Profile for plasterboard
- 5. U-shaped suspension

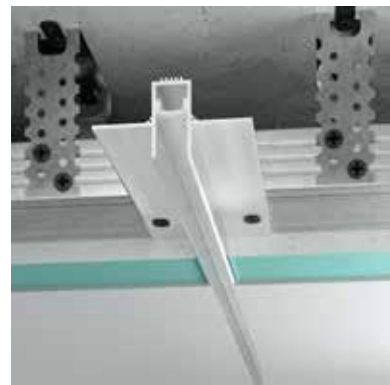

F2.D1320L12 – no cover 12 EUR

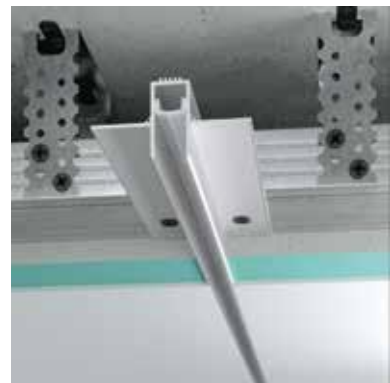

F2.D1320L12A – Anodized cover 19 EUR

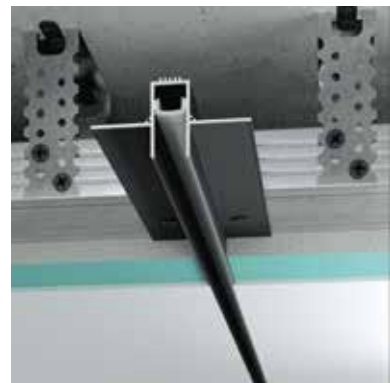

F2.D1320L12B – painted in Black* (RAL 9005 matte) 19 EUR

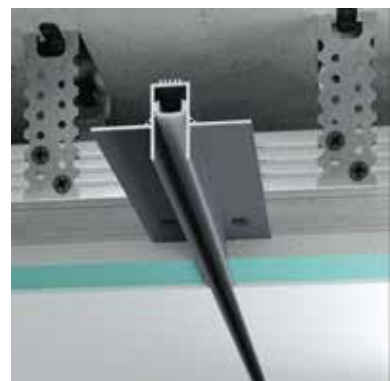

F2.D1320L12R – any RAL palette color* 20 EUR

F2.2030

Aluminium shadowline profile. It is installed to the joint lines of the wall and the ceiling to provide a hanging ceiling effect of the entire room. Can be used as a shadowline plinth.

Designed for gypsum plasterboard systems, it is easy to mount and complements modern design solutions.

Material — Aluminum
LED strip channel — without

Length — 3000 mm
Height — 56,6 mm
Width — 49,1 mm

Covering:
> no cover
> Anodized cover, Silver, 15 micron
> painted in Black* (RAL 9005 matte)
> any RAL palette color*

*powder paint

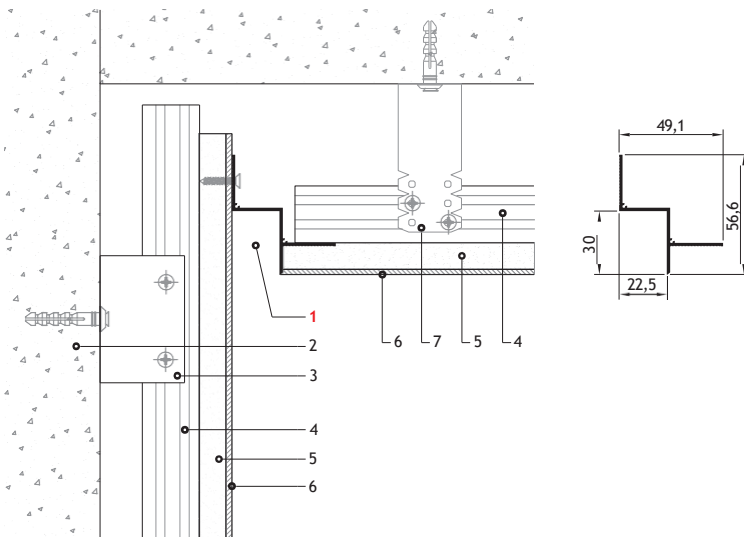

1. Profile F2.2030
2. The wall
3. Fastening of the suspension is straight
4. Profile for plasterboard

5. GKL
6. Putty
7. U-shaped suspension

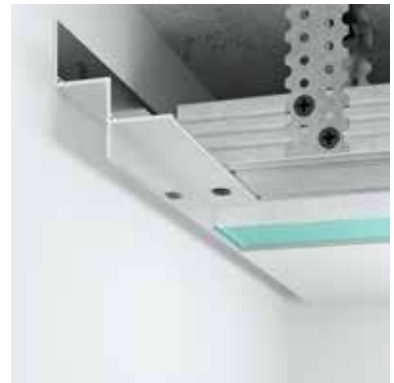

F2.2030 — no cover 10 EUR



F2.2030A — Anodized cover 16 EUR



F2.2030B — painted in Black* (RAL 9005 matte) 16 EUR



F2.2030R — any RAL palette color* 18 EUR

F2.D2030

Aluminium shadowline profile Separated. It is used to create a shadowline on walls and ceilings to visually separate them.

Designed for gypsum plasterboard systems, it is easy to mount and complements modern design solutions.

Material — Aluminum
LED strip channel — without

Length — 3000 mm
Height — 31,6 mm
Width — 73,2 mm

Covering:
> no cover
> Anodized cover, Silver, 15 micron
> painted in Black* (RAL 9005 matte)
> any RAL palette color*
*powder paint



Accessories:
> End cap F2.D2030P

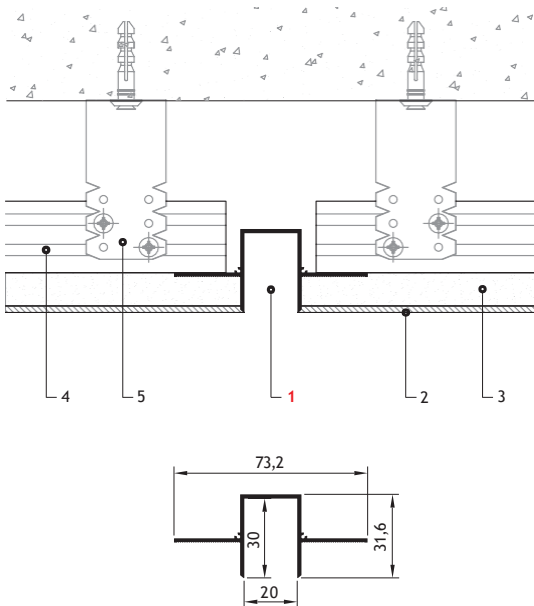

- | | |
|---------------------|-----------------------------|
| 1. Profile F2.D2030 | 4. Profile for plasterboard |
| 2. Putty | 5. U-shaped suspension |
| 3. GKL | |

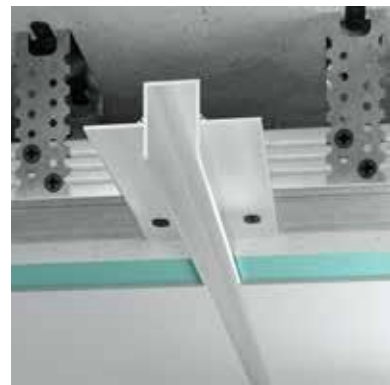

F2.D2030 — no cover 13 EUR

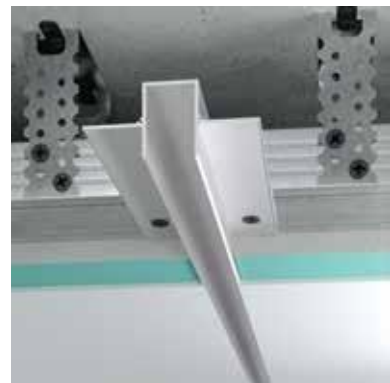

F2.D2030A — Anodized cover 19 EUR

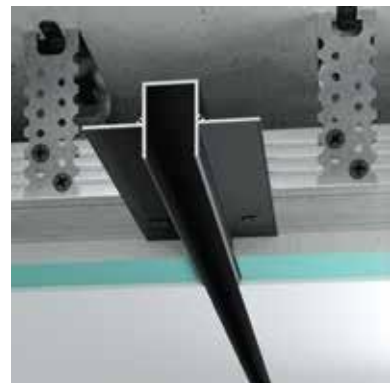

F2.D2030B — painted in Black* (RAL 9005 matte) 19 EUR

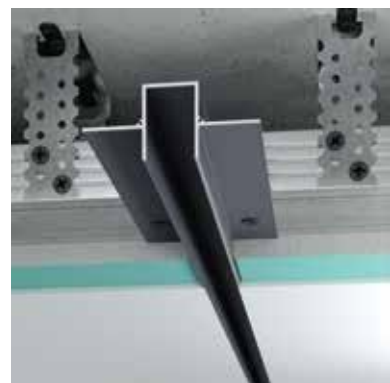





F2.D2030R — any RAL palette color* 21 EUR

F2.2040L16

Aluminium shadowline profile with a LED strip. It is mounted to the joint lines of the wall and the ceiling to provide a hanging ceiling effect of the entire room. With a LED strip channel 16 mm width provides additional room illumination.

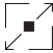
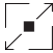
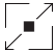
Designed for gypsum plasterboard systems, it is easy to mount and complements modern design solutions.

	Material	—	Aluminum
	LED strip channel	—	to 16 mm
<hr/>			
	Length	—	3000 mm
	Height	—	66,6 mm
	Width	—	66,1 mm
<hr/>			
	Covering:		
	> no cover		
	> Anodized cover, Silver, 15 micron		
	> painted in Black* (RAL 9005 matte)		
	> any RAL palette color*		
<hr/>			
	*powder paint		

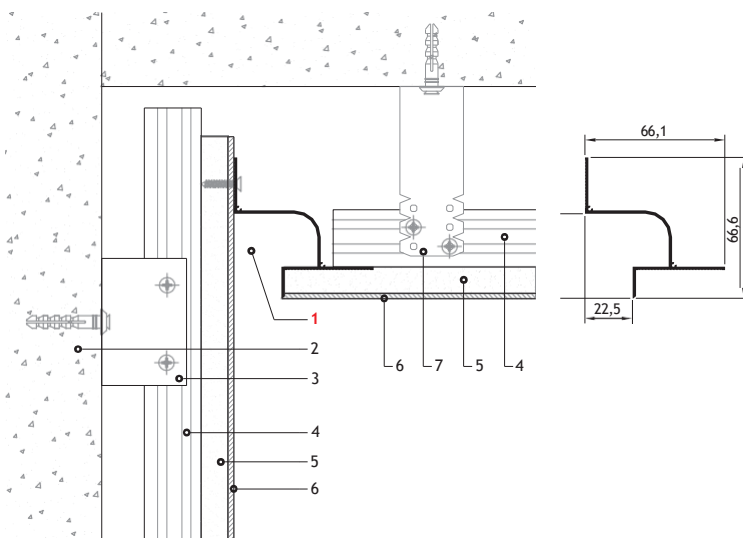

- | | |
|--|------------------------|
| 1. Profile F2.2040L16 | 5. GKL |
| 2. The wall | 6. Putty |
| 3. Fastening of the suspension is straight | 7. U-shaped suspension |
| 4. Profile for plasterboard | |



F2.2040L16 – no cover 15 EUR



F2.2040L16A – Anodized cover
20 EUR



F2.2040L16B – painted in Black*
(RAL 9005 matte) 20 EUR



F2.2040L16R – any RAL palette color*
22 EUR

F2.D2040L16

Aluminium shadowline profile Separated with a LED strip. It is used to create a shadowline on walls and ceilings to visually separate them. With a LED strip channel 16 mm width provides additional room illumination.

Designed for gypsum plasterboard systems, it is easy to mount and complements modern design solutions.

Material	—	Aluminum
LED strip channel	—	to 16 mm

Length	—	3000 mm
Height	—	41,6 mm
Width	—	90,2 mm

 Covering:	>	no cover
	>	Anodized cover, Silver, 15 micron
	>	painted in Black* (RAL 9005 matte)
	>	any RAL palette color*
		*powder paint



Accessories:
 > Left, Right end cap F2.D2040L16P(L/R)

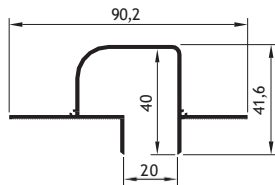
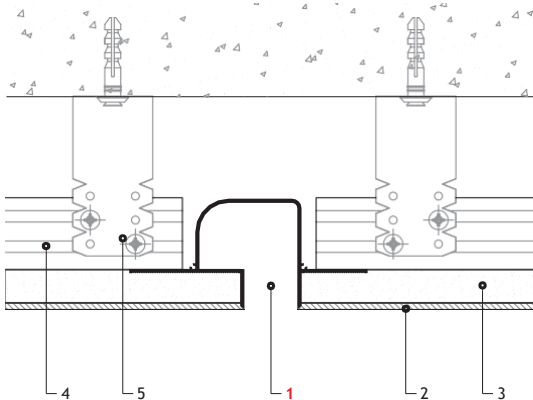

- | | |
|------------------------|-----------------------------|
| 1. Profile F2.D2040L16 | 4. Profile for plasterboard |
| 2. Putty | 5. U-shaped suspension |
| 3. GKL | |

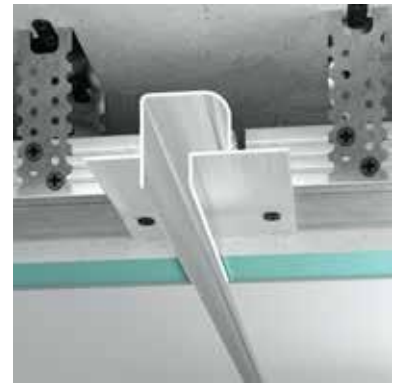

F2.D2040L16 – no cover **16 EUR**

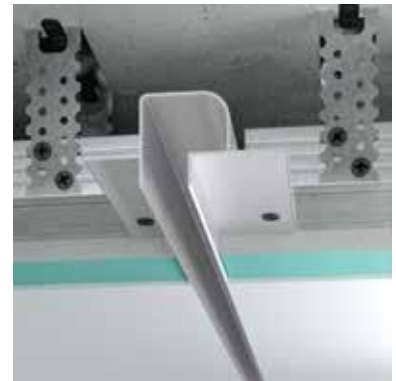

F2.D2040L16A – Anodized cover **23 EUR**

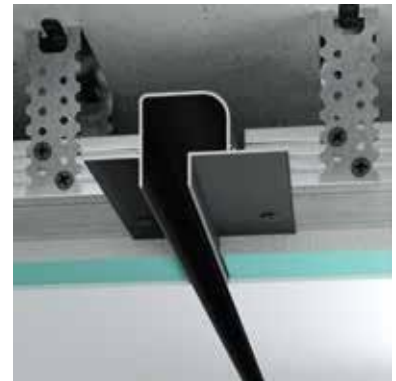

F2.D2040L16B – painted in Black* (RAL 9005 matte) **23 EUR**

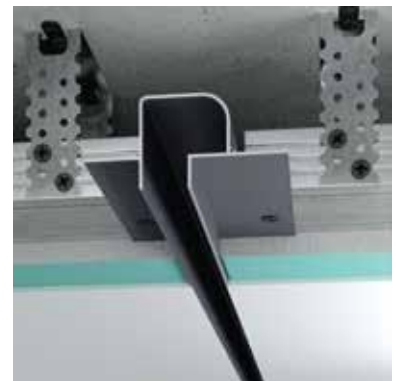





F2.D2040L16R – any RAL palette color* **25 EUR**

F3.16L24

Aluminium shadowline profile with a LED strip. It is used to create a shadowline 5+ mm width at the junction of the wall and the ceiling to provide a hanging ceiling effect of the entire room. With a LED strip channel 24 mm width provides additional room illumination.

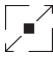
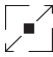
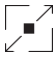
Designed for gypsum plasterboard systems, it is easy to mount and complements modern design solutions.

	Material	—	Aluminum
	LED strip channel	—	to 24 mm
<hr/>			
	Length	—	300 mm
	Height	—	50 mm
	Width	—	43 mm
<hr/>			
	Covering:		
	> no cover		
	> Anodized cover, Silver, 15 micron		
	> painted in Black* (RAL 9005 matte)		
	> any RAL palette color*		
<hr/>			
	*powder paint		

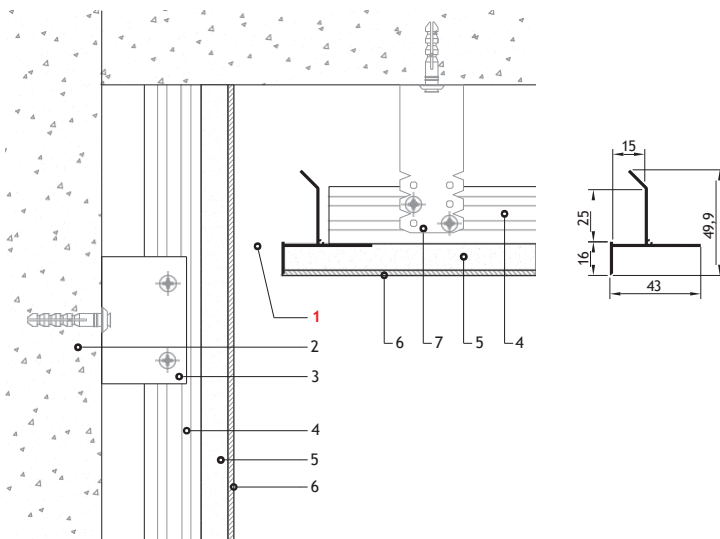

- | | |
|--|------------------------|
| 1. Profile F3.16L24 | 5. GKL |
| 2. The wall | 6. Putty |
| 3. Fastening of the suspension is straight | 7. U-shaped suspension |
| 4. Profile for plasterboard | |



F3.16L24 – no cover **11 EUR**

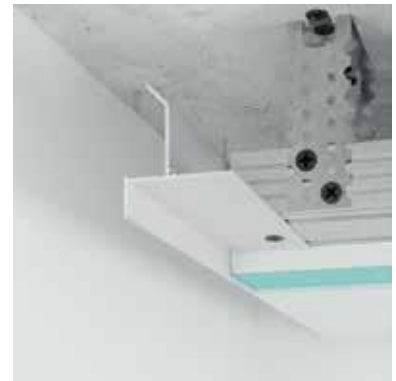

F3.16L24A – Anodized cover **14 EUR**



F3.16L24B – painted in Black* (RAL 9005 matte) **14 EUR**

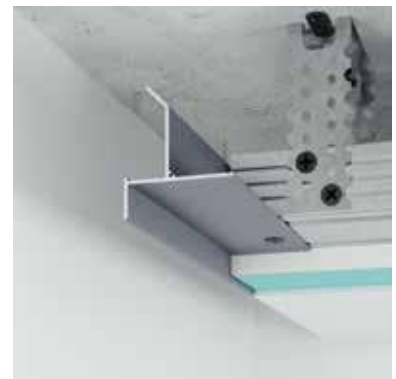





F3.16L24R – any RAL palette color* **15 EUR**

F2.4060L24

Aluminium shadowline profile with a LED strip. It is used to create a shadowline 40+ mm width at the junction of the wall and the ceiling to provide a hanging ceiling effect of the entire room. With a LED strip channel 24 mm width provides additional room illumination.

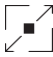
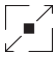
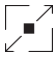
Designed for gypsum plasterboard systems it is easy to mount and complements modern design solutions.

	Material	—	Aluminum
	LED strip channel	—	to 24 mm
<hr/>			
	Length	—	300 mm
	Height	—	86,5 mm
	Width	—	78 mm
<hr/>			
	Supplemented with:		
	> Diffuser 25 mm F0.LD25		
<hr/>			
	Covering:		
	> no cover		
	> Anodized cover, Silver, 15 micron		
	> painted in Black* (RAL 9005 matte)		
	> any RAL palette color*		
<hr/>			
	*powder paint		

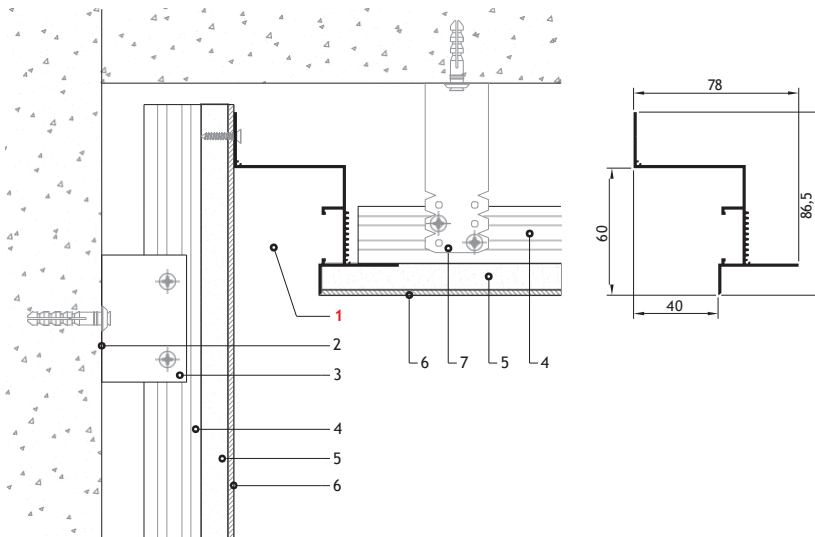

- | | |
|--|------------------------|
| 1. Profile F2.4060L24 | 5. GKL |
| 2. The wall | 6. Putty |
| 3. Fastening of the suspension is straight | 7. U-shaped suspension |
| 4. Profile for plasterboard | |



F2.4060L24 — no cover **20 EUR**

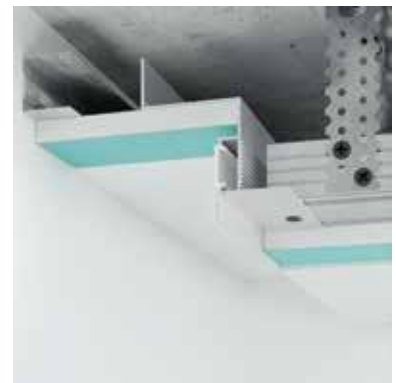

F2.4060L24A — Anodized cover **29 EUR**



F2.4060L24B — painted in Black* (RAL 9005 matte) **29 EUR**

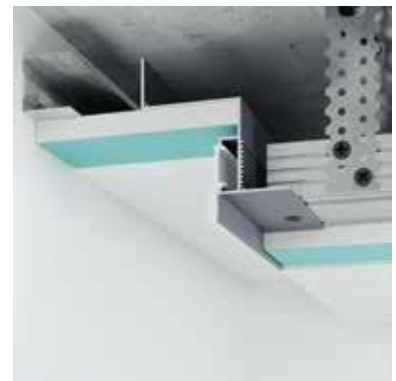

F2.4060L24R — any RAL palette color* **31 EUR**

F2.10 v1

“Swallow tail” shadowline profile.
It is installed to the joint lines of the wall and the ceiling to provide a hanging ceiling effect of the entire room and can also be used as a shadowline plinth.

Designed for gypsum plasterboard systems, it is easy to mount and complements modern design solutions.

Material	—	Aluminum
LED strip channel	—	without
<hr/>		
Length	—	3000 mm
Height	—	40 mm
Width	—	15 mm
<hr/>		
Covering:		
> no cover		
> Anodized cover, Silver, 15 micron		
> painted in Black* (RAL 9005 matte)		
> any RAL palette color*		
<hr/>		
*powder paint		

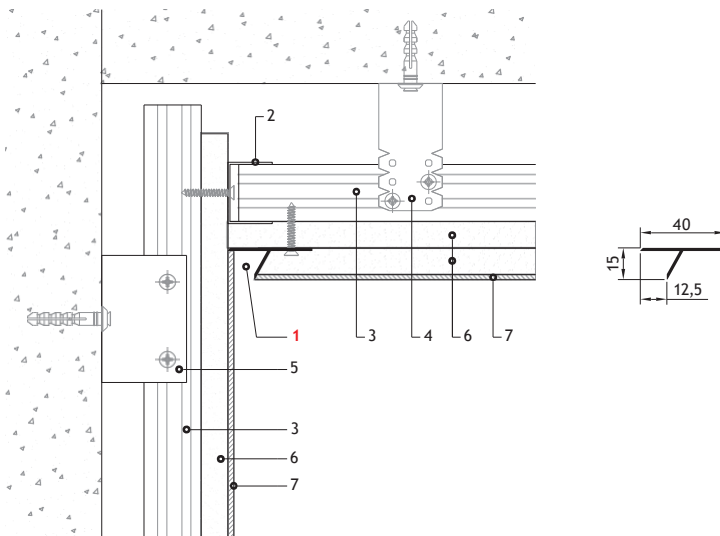

- | | |
|-----------------------------|-------------------|
| 1. Profile F2.10 | 5. Flat hanger ES |
| 2. Profile UD27 | 6. GKL |
| 3. Profile for plasterboard | 7. Putty |
| 4. U-shaped suspension | |

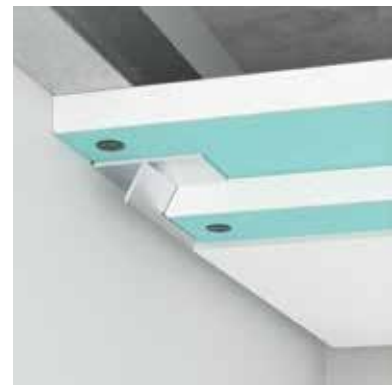

F2.10 – no cover 6 EUR



F2.10A – Anodized cover 7 EUR

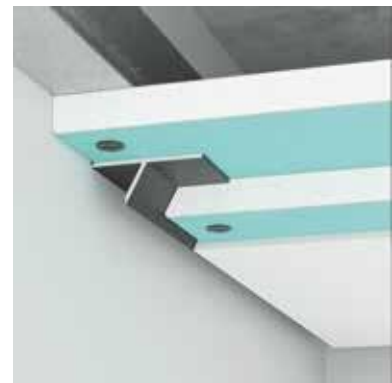

F2.10B – painted in Black* (RAL 9005 matte) 7 EUR

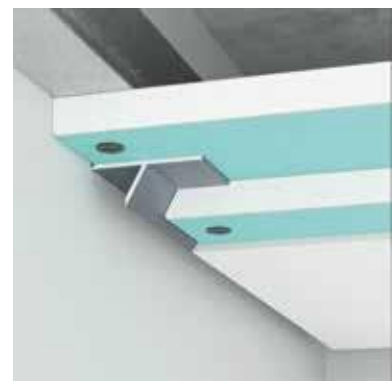

F2.10R – any RAL palette color* 9 EUR

F2.10 v2

“Swallow tail” shadowline profile.
It is installed to the joint lines of the wall and the ceiling to provide a hanging ceiling effect of the entire room and can also be used as a shadowline plinth.

Designed for gypsum plasterboard systems, it is easy to mount and complements modern design solutions.

Material — Aluminum
LED strip channel — without

Length — 3000 mm
Height — 40 mm
Width — 15 mm

Covering:
> no cover
> Anodized cover, Silver, 15 micron
> painted in Black* (RAL 9005 matte)
> any RAL palette color*

*powder paint

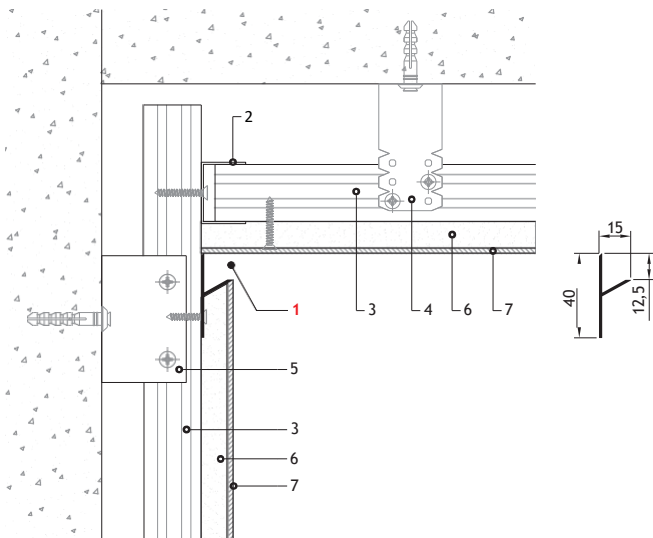

1. Profile F2.10
2. Profile UD27
3. Profile for plasterboard
4. U-shaped suspension

5. Flat hanger ES
6. GKL
7. Putty



F2.10 – no cover

6 EUR



F2.10A – Anodized cover

7 EUR



F2.10B – painted in Black*
(RAL 9005 matte)

7 EUR



F2.10R – any RAL palette color*

9 EUR

F0.LD13

Diffuser 13 mm White Matte.

Snug fit provides dust and moisture protection with 60-70% of light transmission. UV and heat resistance. Does not become fragile or turn yellow over time.

Material	—	TPE
Light transmission	—	60% - 70%

> Length	—	3000 mm
> Width	—	13 mm

It is used with concealed plinth mounting systems F2.1320L12 and F2.D1320L12



4 EUR



F0.LD13 – Diffuser 13 mm + shadowline profile F2.1320L12

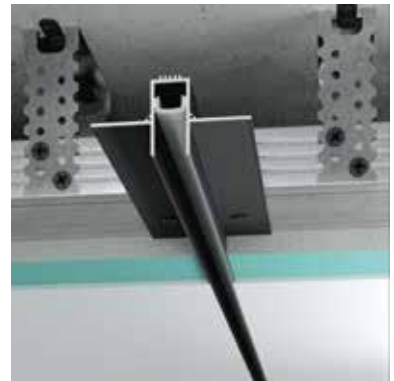

F0.LD13 – Diffuser 13 mm + shadowline profile F2.D1320L12

F0.LD25

Diffuser 13 mm White Matte.

Snug fit provides dust and moisture protection with 60-70% of light transmission. UV and heat resistance. Does not become fragile or turn yellow over time.

Material	—	TPE
Light transmission	—	60% - 70%

> Length	—	3000 mm
> Width	—	25 mm

It is used with concealed plinth mounting systems F2.4060L24



6 EUR



F0.LD25 – Diffuser 25 mm + shadowline profile F2.4060L24

Vesse 3, Tallinn
11415 Estonia

+372 6096919
+372 53333789
+372 56227056

www.premiumdesign.ee
www.premium-design.ee

Stretch Ceilings
PREMIUM DESIGN